



Redmayne Arnold & Harris
estate agents, letting agents & surveyors

rah.co.uk



TO LET



31 Moorfield Road, Duxford, Cambridge, CB22 4PP

£1,500 PCM



THE PROPERTY

A two bedroom family home, located in the popular village of Duxford allowing excellent access to M11. The property comprises kitchen/breakfast room, study area, downstairs W/C, living room, two double bedrooms with a potential third bedroom off the second, giving the option of nursery/dressing room, and a family bathroom. The property has a good size garden to the rear with gated access. The property will be managed by RAH.

Council Tax Band: C
 EPC Rating: D
 Deposit: £1730
 Holding Deposit: £340

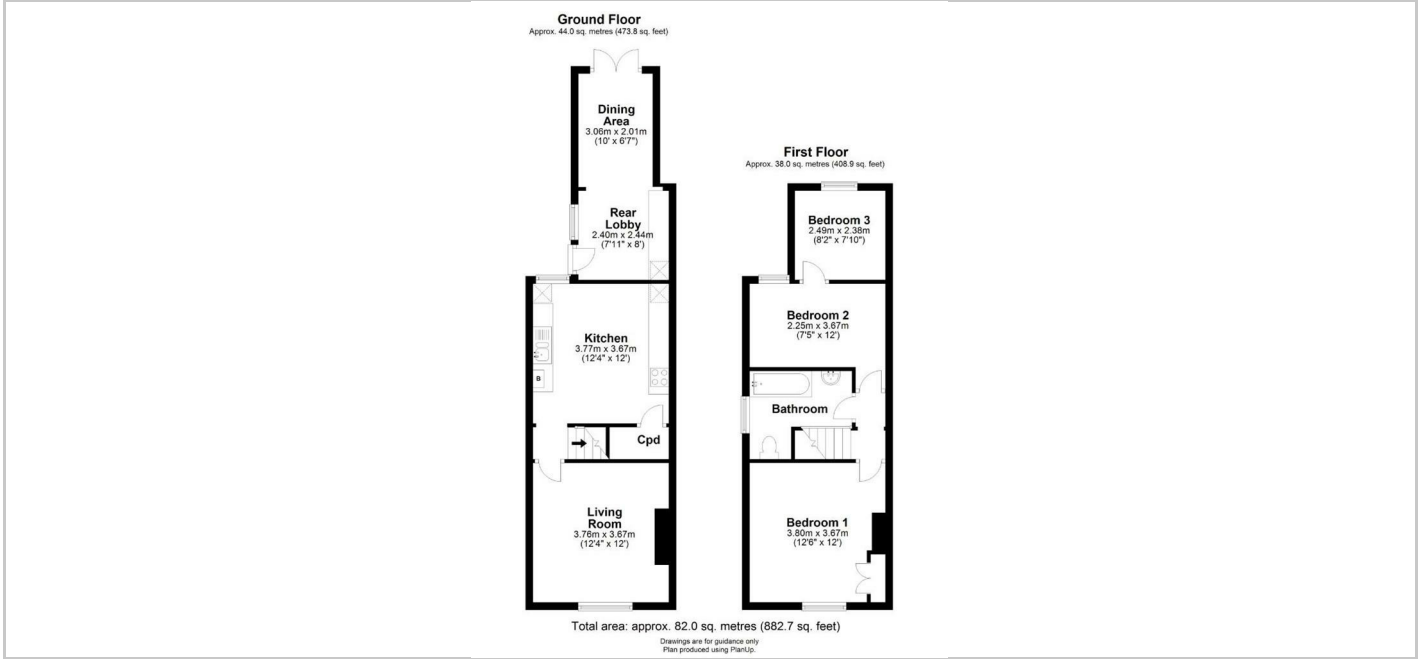

Directions

SITUATION

